

# DRINKING SYSTEMS

## GESTATION

### CONSTANT WATER LEVEL STAINLESS STEEL TUBE

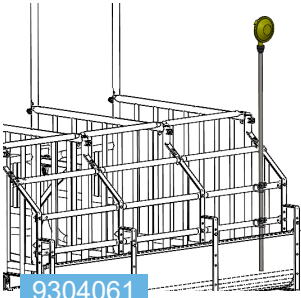

9304061

- Kit composition :
  - 1 VRH 3D membrane valve
  - 1 Ø15x21 mm stainless steel tube, L1,2m
  - 2 galvanized fixing brackets, M8 thread Ø
- Pressure : 0.5 to 2.5 bar
- Flow rate : 3.6 to 4.2 L/min
- Easy valve opening/closing
- Needs no electrical or mechanical energy

### ½ INCH DRINKER KIT



9303127

- Kit composition :
  - 1 Ø15 x 21 mm stainless steel tube, L 750 mm, 30° elbow bend, 4 attachment holes on 2 welded lugs
  - 1 stainless steel push button nipple drinker
- Fasteners not included
- Suitable for mating stall, gestation stall, loading quay

### WATERING START-END ON FEEDING STATION

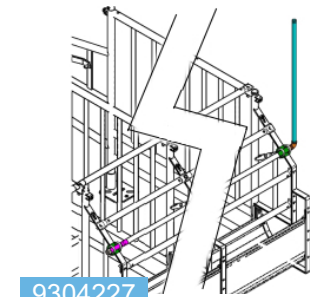

9304227

- Kit composition :
  - 1 Ø15 x 21 mm stainless steel tube, L 750 mm
  - 2 stainless steel brackets
  - Ø15 x 21 stainless-steel fasteners and cap included

### STAINLESS STEEL TUBE & DRINKER ASSEMBLY



9101110

- Kit composition :
  - 1 Ø15x21 mm stainless steel tube, L 1m
  - 1 stainless steel drinker & nipple drinker
  - Fasteners included (stainless steel) for fixing to 50 mm PP partition
- Dimensions (mm): HT 1400, W 210, D 160
- Adjustable water flow rate up to 5 L/min
- 2 Ø8 drilled holes for fitting drinker

### WATERING ON FEEDING STATION (1 DRINKER / PLACE)

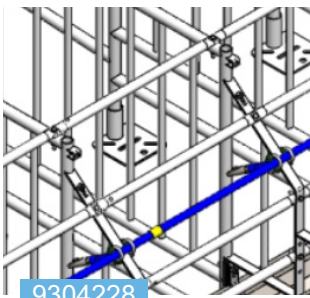

9304228

- Kit composition :
  - 1 pushbutton stainless steel nipple drinker, ½ inch ♂ nozzle,
  - 2 or 3-place stainless steel tube, ½ inch
  - 2 stainless steel fixing brackets
  - Stainless steel nipple and sleeve
  - Fasteners and resin included

### 1/2" DRINKER KIT ON BARRED BARRIER

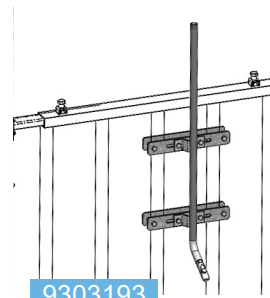

9303193

- Kit composition :
  - 1 Ø15 x 21 mm stainless steel tube, L 750 mm
  - 1 pushbutton stainless steel nipple drinker, ½ inch ♂ nozzle,
  - Fasteners included
- Suitable for mating stall, gestation stall, fattening

### STAINLESS STEEL DRINKER ON BARRED BARRIER



9304013

- Kit composition :
  - 1 drinker & nipple drinker
  - 1 Ø15X21 mm tube, L 1000 mm
  - Stainless steel fasteners included
- Dimensions : HT300, W210, D160
- Adjustable water flow rate up to 2.5 L/min
- To be attached 35-40 cm from the ground
- Also available as drinker alone (Ref. 1101007)

# DRINKING SYSTEMS

## GESTATION

### WATER JOIN KIT Ø10 (0.5 M) BETWEEN 2 TUBES

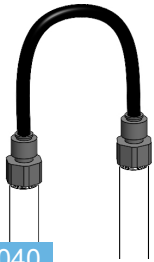

9305040

- Kit composition :  
2 female fast connectors in G1/2 and Ø10 plastic tube
- Adaptable length to suit requirement

### DOUBLE WATER JOIN KIT Ø10 FOR SUPPLY IN Ø25

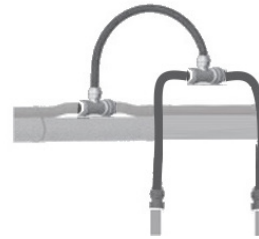

9305039

- Kit composition :  
2 delivery points  
1 fast connector for Ø25 tube  
Ø10 plastic tube  
At the ends, female fast connectors in G1/2
- Adaptable length to suit requirement

### WATER JOIN KIT Ø10 (2 M) FOR SUPPLY IN Ø25

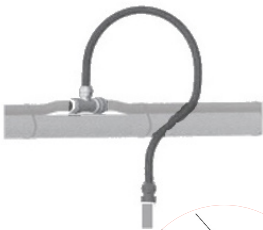

9305038

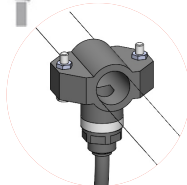

- Kit composition :  
1 fast connector for Ø25 tube  
2m of Ø10 plastic tube  
1 female fast connector in G1/2
- Adaptable length to suit requirement

# DRINKING SYSTEMS

## FARROWING

### NIPPLE DRINKER ON GALVANISED LID



9301022

- Kit composition :
  - 1 stainless steel nipple drinker, ♂ nozzle
  - 1 Ø15 x 21 MF L 750 mm tube
  - 2 brackets for Ø15 x 21 tube
  - 2 shims for stainless steel tube
  - Fasteners included
- Suited for use with a galvanised lid above the trough

### TUBE L 750 MM (INCLUDING BRACKET)

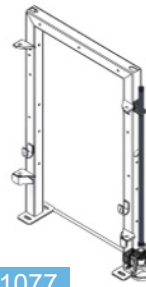

9101077

- Kit composition :
  - 1 Ø15 x 21 mm stainless steel tube, L 750 mm
- Fasteners included for assembly of the system on the farrowing stall frame (stainless steel fasteners)
- Piglet drinker not supplied

### SINGLE WATERTEK ON FRAME L 500 MM

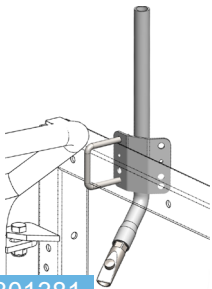

9301381

- Kit composition :
  - 1 Ø15x21 MF, L500mm, 30° elbow bend
  - 1 pushbutton nipple drinker
  - 1 U bracket for Ø15 x 21 tube
  - Stainless steel M8 fasteners
- Fixed to the top of the farrowing stall frames
- Rotational moulded clamp option on trough

### PIGLET DRINKER, ½ INCH ♀ NOZZLE



1102001

- Stainless steel nipple drinker
- Dimensions : H 120, W 110, D 72
- Threaded ½ inch ♀ nozzle
- 2 x Ø11 drill holes, 85 mm centre distance
- Ø15 x 21 mm tube not supplied
- To be fixed 6-8 cm from the ground
- Also available as nipple drinker alone (Ref. 1107302)

### DOUBLE WATERTEK



9301023

- Kit composition :
  - 1 stainless steel tube, Ø15 x 21, L 900 mm
  - 1 stainless steel pushbutton nipple drinker
  - 1 stainless steel drinker for piglet
  - 2 stainless steel brackets for Ø15 x 21 tube
  - Stainless steel fasteners included

### TUBE AND WEANING DRINKER ASSEMBLY



9101097

- Kit composition :
  - 1 Ø15 x 21 mm tube, L 750 mm
  - 1 drinker with nipple drinker
- Fastenings included for assembly on 50 mm-thick PVC partition
- Dimensions: H 233, W 140, D 110
- 2 x Ø8 drill holes, 87mm interaxial
- Adjustable water flow rate up to 5L / min

### DUAL SOW / PIGLET STAINLESS STEEL BOWL KIT

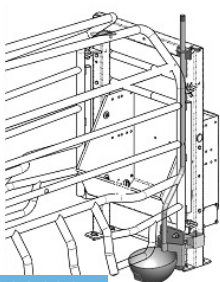

9301385

- Kit composition :
  - 1 stainless steel tube, Ø15 x 21, L 1000 mm, 30° elbow bend
  - 1 galvanised steel bracket
  - 1 drinker bowl with nipple drinker
  - Stainless-steel fasteners included
- 2 x Ø12 drill holes, 76 mm interaxial
- Water flow rate adjustment by screw on tube

### ST. STEEL PIPE + DRINKER FOR 30X500 PANEL

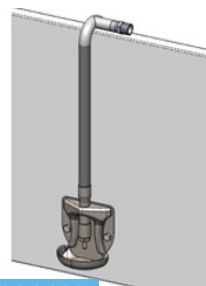

9301423

- Kit composition :
  - 1 stainless-steel piglet drinker
  - 1 stainless-steel tube, Ø15 x 21, L 320 mm
  - 1 stainless-steel elbow Ø15 x 21 MF 90°
- Stainless-steel fixations, screws and bolts included

# DRINKING SYSTEMS

## FARROWING

### WATER JOIN KIT Ø10 (0.5 M) BETWEEN 2 TUBES

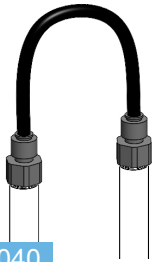

9305040

- Kit composition :  
2 female fast connectors in G1/2 and Ø10 plastic tube
- Adaptable length to suit requirement

### DOUBLE WATER JOIN KIT Ø10 FOR SUPPLY IN Ø25

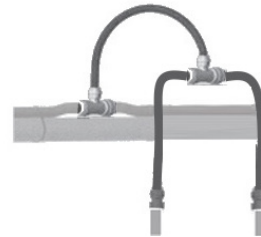

9305039

- Kit composition :  
2 delivery points  
1 fast connector for Ø25 tube  
Ø10 plastic tube  
At the ends, female fast connectors in G1/2
- Adaptable length to suit requirement

### WATER JOIN KIT Ø10 (2 M) FOR SUPPLY IN Ø25

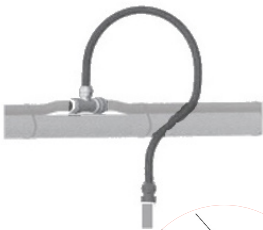

9305038

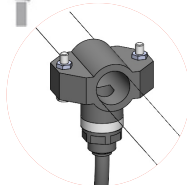

- Kit composition :  
1 fast connector for Ø25 tube  
2m of Ø10 plastic tube  
1 female fast connector in G1/2
- Adaptable length to suit requirement

# DRINKING SYSTEMS

## WEANING

### STAINLESS STEEL TUBE KIT L750 MM & 1 DRINKER



9101097

- Kit composition :
  - 1 Ø15 x 21 mm s.steel tube, L 750 mm
  - 1 s.steel drinker with nipple drinker
  - Stainless steel fasteners for assembling the system on a 35mm-thick PVC partition
- Also available as drinker alone (Ref. 1104005)

### STAINLESS STEEL DRINKER



1104005

- S.steel drinker with nipple drinker, for piglets up to 35 kg
- Threaded ½ inch ♀ nozzle
- Dimensions (mm): H 233, W 140, D 110
- Adjustable water flow rate up to 5L / min
- Ø15 x 21 s.steel tube not supplied
- To be attached 10-15 cm from the ground

### SERIAL SUPPLY KIT AND 1 DRINKER



9302082

- Kit composition :
  - 1 Ø15x21mm s.steel tube, L 750 mm
  - 1 s.steel drinker with nipple drinker
  - 1 stainless steel cap
  - Stainless steel fasteners included for assembling the system on a 35mm-thick PVC partition
- Option :
  - Connection kit, L 400 mm

### WATER JOIN KIT Ø10 (0.5 M) BETWEEN 2 TUBES

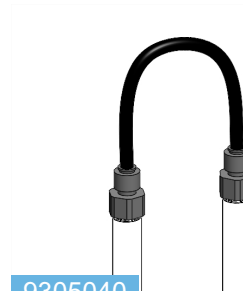

9305040

- Kit composition :
  - 2 female fast connectors in G1/2 and Ø10 plastic tube
- Adaptable length to suit requirement

### SERIAL SUPPLY KIT AND 2 DRINKERS



9302083

- Kit composition :
  - 1 Ø15x21mm s.steel tube, L 750 mm
  - 2 s.steel drinkers with nipple drinker
  - 1 stainless steel cap
  - Stainless steel fasteners included for assembling the system on a 35mm-thick PVC partition
- Option :
  - Connection kit, L 400 mm

### WATER JOIN KIT Ø10 (2 M) FOR SUPPLY IN Ø25

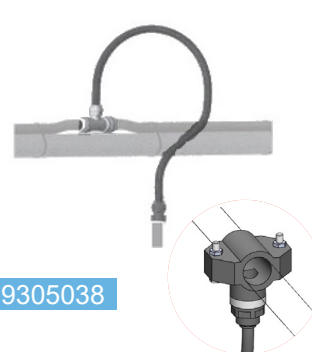

9305038

- Kit composition :
  - 1 fast connector for Ø25 tube
  - 2m of Ø10 plastic tube
  - 1 female fast connector in G1/2
- Adaptable length to suit requirement

### SERIAL SUPPLY KIT AND 3 DRINKERS



9302088

- Kit composition :
  - 1 Ø15x21mm s.steel tube, L 750 mm
  - 3 s.steel drinkers with nipple drinker
  - 1 stainless steel cap
  - Stainless steel fasteners included for assembling the system on a 35mm-thick PVC partition
- Option :
  - Connection kit, L 400 mm

### DOUBLE WATER JOIN KIT Ø10 FOR SUPPLY IN Ø25



9305039

- Kit composition :
  - 2 delivery points
  - 1 fast connector for Ø25 tube
  - Ø10 plastic tube
  - At the ends, female fast connectors in G1/2
- Adaptable length to suit requirement

# DRINKING SYSTEMS

## FATTENING

### S.STEEL TUBE AND 40 MM DRINKER ASSEMBLY



9303060

- Kit composition :  
1 tube, Ø15 x 21 mm, L 750 mm  
1 s.steel drinker with nipple drinker  
S.steel fasteners for 40 mm-thick PVC or polypropylene partition
- Also exists for 50mm thick partition
- To be fixed 25-30 cm from the ground
- Also available as drinker alone (Ref. 1105004)

### DISTRIBUTION ON TROUGH WITH 2 NIPPLE DRINKERS

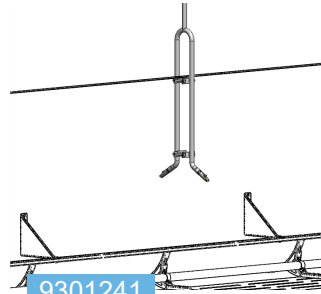

9301241

- Kit composition :  
1 Ø15x21mm s.steel tube, L 1000 mm  
2 stainless steel push button nipple drinkers  
4 stainless steel fasteners included for assembling the system on 50 mm-thick PVC partition

### SERIAL SUPPLY KIT AND DRINKER

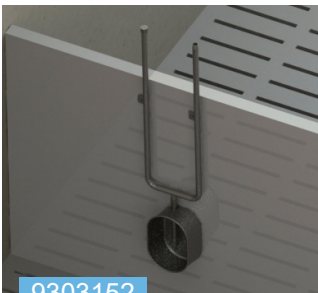

9303152

- Kit composition :  
1 Ø15x21mm s.steel tube, L 750 mm  
1 s.steel drinker with nipple drinker  
1 stainless steel cap  
Stainless steel fasteners included for assembling the system on a 40 or 50 mm-thick PVC partition
- Option :  
Water join kit, L 400 mm

### ½ INCH DRINKER KIT



9303127

- Kit composition :  
1 Ø15 x 21 mm stainless steel tube, L 750 mm, 30° elbow bend, 4 attachment holes on 2 welded lugs  
1 stainless steel push button nipple drinker
- Fasteners not included
- Suitable for mating stall, gestation stall, loading quay

### SERIAL SUPPLY KIT AND 2 DRINKERS

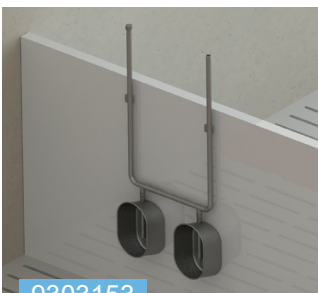

9303153

- Kit composition :  
1 Ø15x21mm s.steel tube, L 750 mm  
2 s.steel drinkers with nipple drinker  
1 stainless steel cap  
Stainless steel fasteners included for assembling the system on a 40 or 50 mm-thick PVC partition
- Option :  
Water join kit, L 400 mm

### ½" DRINKER KIT ON BARRED BARRIER

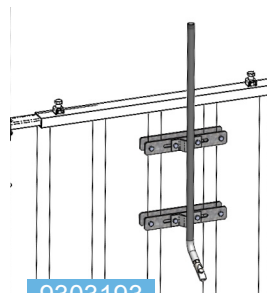

9303193

- Kit composition :  
1 Ø15x21mm s.steel tube, L 750 mm  
1 pushbutton stainless steel nipple drinker, ½ inch ♂ nozzle, Fasteners included
- Suitable for mating stall, gestation stall, fattening

### STAINLESS STEEL DRINKER



1105005

- S.steel drinker with nipple drinker, for pigs from 25 to 110 kg
- Threaded 1/2 inch ♀ nozzle
- Dimensions (mm) :  
H 293, I 192, P 117
- Adjustable water flow rate up to 5L / min
- Ø15 x 21 s.steel tube not supplied
- To be attached 25-30 cm from the ground (3 holes Ø8,5)

### WATER JOIN KIT Ø10 (0.5 M) BETWEEN 2 TUBES

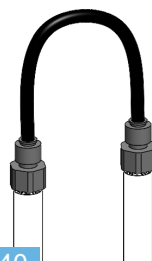

9305040

- Kit composition :  
2 female fast connectors in G1/2 and Ø10 plastic tube
- Adaptable length to suit requirement

# DRINKING SYSTEMS

## FATTENING

### WATER JOIN KIT Ø10 (2 M) FOR SUPPLY IN Ø25

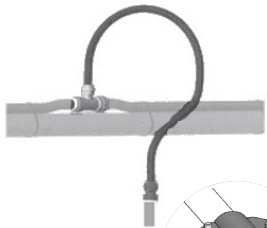

9305038

- Kit composition :
  - 1 fast connector for Ø25 tube
  - 2m of Ø10 plastic tube
  - 1 female fast connector in G1/2
- Adaptable length to suit requirement

### DOUBLE WATER JOIN KIT Ø10 FOR SUPPLY IN Ø25

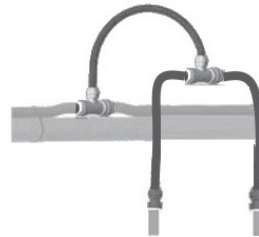

9305039

- Kit composition :
  - 2 delivery points
  - 1 fast connector for Ø25 tube
  - Ø10 plastic tube
  - At the ends, female fast connectors in G1/2
- Adaptable length to suit requirement

# DRINKING SYSTEMS

## MATING STALLS

### ½ INCH DRINKER KIT



9303127

- Kit composition :  
1 Ø15 x 21 mm stainless steel tube, L 750 mm, 30° elbow bend, 4 attachment holes on 2 welded lugs  
1 stainless steel push button nipple drinker
- Fasteners not included
- Suitable for mating stall, gestation stall, loading quay

### ½" DRINKER KIT ON BARRED BARRIER

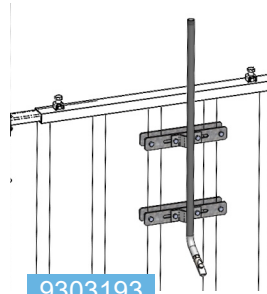

9303193

- Kit composition :  
1 Ø15 x 21 mm stainless steel tube, L 750 mm  
1 pushbutton stainless steel nipple drinker, ½ inch ♂ nozzle,  
Fasteners included
- Suitable for mating stall, gestation stall, fattening

### STAINLESS STEEL DRINKER ON BARRED BARRIER



9304013

- Kit composition :  
1 drinker & nipple drinker  
1 Ø15x21 mm tube, L 1000 mm  
Stainless steel fasteners included
- Dimensions : HT300, W210, D160
- Adjustable water flow rate up to 2.5L/min
- To be attached 35-40 cm from the ground
- Also available as drinker alone (Ref. 1101007)

### WATER JOIN KIT Ø10 (0.5 M) BETWEEN 2 TUBES

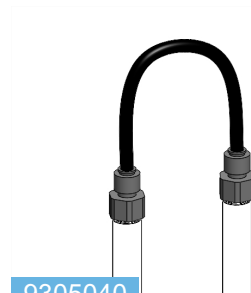

9305040

- Kit composition :  
2 female fast connectors in G1/2 and Ø10 plastic tube
- Adaptable length to suit requirement

### STAINLESS STEEL DRINKER



1101007

- S.steel drinker with nipple drinker, for sows and boars
- Threaded 1/2 inch ♀ nozzle
- Dimensions (mm) :  
H 300, I 210, P 160
- Adjustable water flow rate up to 5L/min
- Ø15 x 21 s.steel tube not supplied
- To be attached 35 cm from the ground minimum

### WATER JOIN KIT Ø10 (2 M) FOR SUPPLY IN Ø25

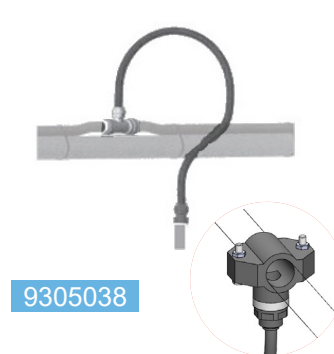

9305038

- Kit composition :  
1 fast connector for Ø25 tube  
2m of Ø10 plastic tube  
1 female fast connector in G1/2
- Adaptable length to suit requirement

### STAINLESS STEEL TUBE & DRINKER ASSEMBLY

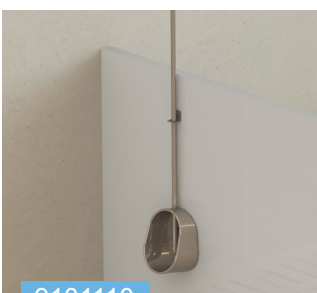

9101110

- Kit composition :  
1 Ø15x21 mm stainless steel tube, L 1m  
1 stainless steel drinker & nipple drinker  
Fasteners included (stainless steel) for fixing to 50 mm PP partition
- Dimensions (mm): HT 1400, W210, D 160
- Adjustable water flow rate up to 5 L/min
- 2 Ø8 drilled holes for fitting drinker

### DOUBLE WATER JOIN KIT Ø10 FOR SUPPLY IN Ø25



9305039

- Kit composition :  
2 delivery points  
1 fast connector for Ø25 tube  
Ø10 plastic tube  
At the ends, female fast connectors in G1/2
- Adaptable length to suit requirement